

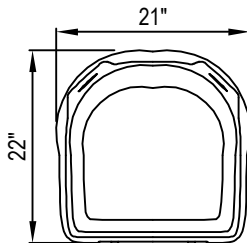

AQUASPACE INC.  
 901 AQUALAND WAY  
 ST. CHARLES, IL 60174  
 TOLL FREE: 1-877-766-3489  
 PHONE: (630) 659-2000  
 FAX: (630) 659-2100  
 www.aquascapeinc.com

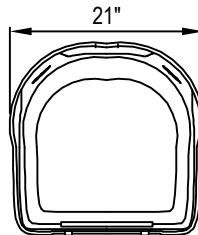

BOTTOM VIEW



TOP VIEW

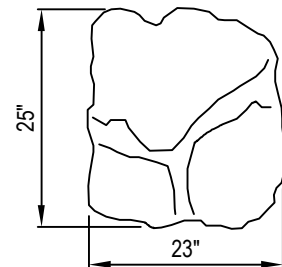

ROCK TOP

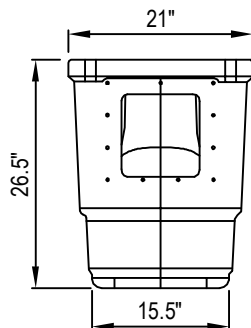

FRONT VIEW

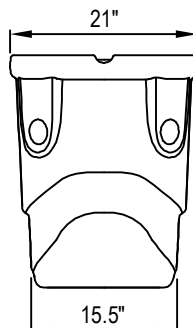

REAR VIEW

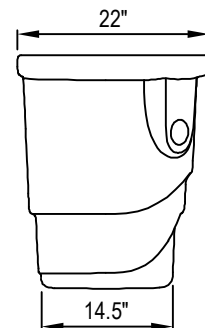

SIDE VIEW

#### **SIGNATURE SERIES 1000 POND SKIMMER**

21" W X 22" D X 26.5 H

- COMPATIBLE WITH BOTH SIGNATURE SERIES 2500 & 6000 BIOFALLS FILTER
- HANDLES HORIZONTAL PUMPS UP TO 10000 GPH
- POND SIZES UP TO 1000 SQ. FT.
- COMES STANDARD FOR USE WITH 2" FLEX PVC
- INCLUDES 1 FILTER MAT
- CAN HANDLE 2 PUMPS

#### **NOTES:**

1. INSTALLATION TO BE COMPLETED IN ACCORDANCE WITH MANUFACTURER'S SPECIFICATIONS.
2. DO NOT SCALE DRAWING.
3. THIS DRAWING IS INTENDED FOR USE BY ARCHITECTS, ENGINEERS, CONTRACTORS, CONSULTANTS AND DESIGN PROFESSIONALS FOR PLANNING PURPOSES ONLY. THIS DRAWING MAY NOT BE USED FOR CONSTRUCTION.
4. ALL INFORMATION CONTAINED HEREIN WAS CURRENT AT THE TIME OF DEVELOPMENT BUT MUST BE REVIEWED AND APPROVED BY THE PRODUCT MANUFACTURER TO BE CONSIDERED ACCURATE.
5. CONTRACTOR'S NOTE: FOR PRODUCT AND COMPANY INFORMATION VISIT [www.CADdetails.com/info](http://www.CADdetails.com/info) AND ENTER REFERENCE NUMBER

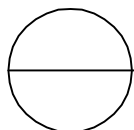

## AQUASCAPE SKIMMER

AQUASCAPE SKIMMER: SIGNATURE SERIES 1000 POND SKIMMER